

Unit A3 - Proposed GA Ground Floor Plan
1:200
Detail 1

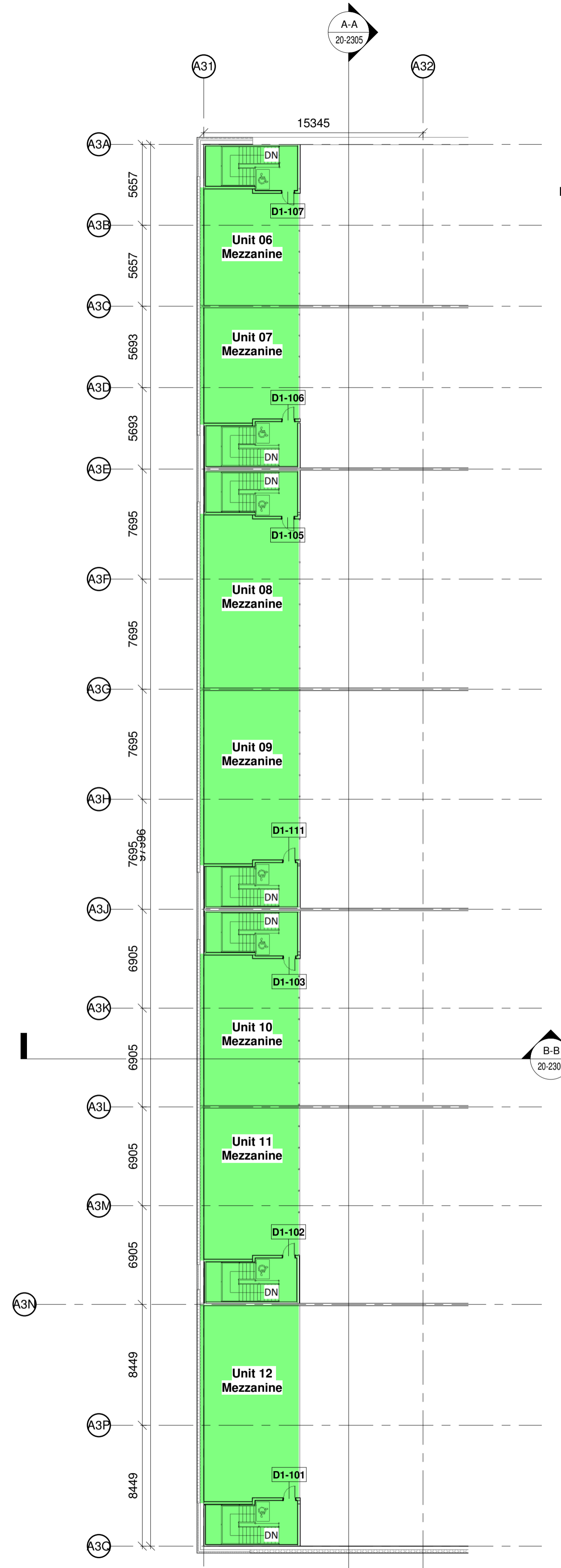

Unit A3 - Proposed GA First Floor Plan
1:200
Detail 2

KEY

 Warehouse Area	 Office / Core Ground Floor Area
 Office / Mezzanine First Floor Area	

Unit 06

Warehouse	257 sqm	2766 sqft
Core / Office Ground Floor	18 sqm	194 sqft
Mezzanine / Office First Floor	73 sqm	786 sqft
Total	348 sqm	3746 sqft

Unit 07

Warehouse	257 sqm	2766 sqft
Core / Office Ground Floor	18 sqm	194 sqft
Mezzanine / Office First Floor	73 sqm	786 sqft
Total	348 sqm	3746 sqft

Unit 08

Warehouse	446 sqm	4801 sqft
Core / Office Ground Floor	18 sqm	194 sqft
Mezzanine / Office First Floor	100 sqm	1076 sqft
Total	564 sqm	6071 sqft

Unit 09

Warehouse	446 sqm	4801 sqft
Core / Office Ground Floor	18 sqm	194 sqft
Mezzanine / Office First Floor	100 sqm	1076 sqft
Total	564 sqm	6071 sqft

Unit 10

Warehouse	398 sqm	4284 sqft
Core / Office Ground Floor	18 sqm	194 sqft
Mezzanine / Office First Floor	89 sqm	958 sqft
Total	505 sqm	5436 sqft

Unit 11

Warehouse	398 sqm	4284 sqft
Core / Office Ground Floor	18 sqm	194 sqft
Mezzanine / Office First Floor	89 sqm	958 sqft
Total	505 sqm	5436 sqft

Unit 12

Warehouse	495 sqm	5328 sqft
Core / Office Ground Floor	18 sqm	194 sqft
Mezzanine / Office First Floor	110 sqm	1184 sqft
Total	623 sqm	6706 sqft

(GEA) Gross External Area

(NOTE: TAKEN FROM OUTSIDE FACE OF BUILDING AND CENTRE OF COMPARTMENT WALLS WHERE APPLICABLE)

Unit 06

Warehouse	303 sqm	3261 sqft
Mezzanine	85 sqm	913 sqft
Total	388 sqm	4174 sqft

Unit 07

Warehouse	293 sqm	3154 sqft
Mezzanine	82 sqm	882 sqft
Total	375 sqm	4036 sqft

Unit 08

Warehouse	490 sqm	5274 sqft
Mezzanine	111 sqm	1193 sqft
Total	601 sqm	6467 sqft

Unit 09

Warehouse	487 sqm	5242 sqft
Mezzanine	111 sqm	1193 sqft
Total	598 sqm	6435 sqft

Unit 10

Warehouse	437 sqm	4704 sqft
Mezzanine	99 sqm	1070 sqft
Total	536 sqm	5774 sqft

Unit 11

Warehouse	437 sqm	4704 sqft
Mezzanine	99 sqm	1070 sqft
Total	536 sqm	5774 sqft

Unit 12

Warehouse	549 sqm	5909 sqft
Mezzanine	125 sqm	1346 sqft
Total	674 sqm	7255 sqft

General Notes

Do not scale from this drawing. Only work to written dimensions.

All site dimensions shall be verified by the Contractor on site prior to commencing any works.

This drawing is the property of Fletcher-Rae (UK) Limited (t/a Fletcher-Rae) and copyright is reserved by them. The drawing is not to be copied or disclosed by or to any unauthorised persons without the prior written consent of Fletcher-Rae (UK) Limited.

All sheeting rails to be offset by 25mm from perimeter gridlines, to achieve GEA 0-3%

C01	First Construction Issue	21.04.21	ME	BB
Rev.	Description	Date	ISS	APP

Scale: **As indicated @ A1**

Status: **A Construction**

Drawn By: **CN**

Checked By: **ME**

Date: **25.10.20**

Client: **Chancerygate (Aintree) Ltd**

Project: **Mersey Reach - Phase 2**

Dunnings Bridge Road, Aintree

Sheet Name: **Unit A3**

Proposed GA Plans

Project No.	Orig.	Zone	Level	Type	Role	Cl	Dwg No.	Rev
20038-FRA-A3-ZZ-DR-A-20-2301								C01

fletcher-rae
Architects | Master Planners | Designers
Hill Quays, 5 Jordan Street, Manchester, M15 4PY

t +44 (0) 161 242 1140
f +44 (0) 161 242 1141
w www.fletcher-rae.com
e info@fletcher-rae.com

